

Taping Station Checklist

Height of Unit: 36" 42" SPECIAL _____ (Please Circle)

Depth of Unit: 36" 42" 48" SPECIAL _____ (Please Circle)

Number of Seat Sections: _____

Model #: _____ **Custom Table Configuration:** YES NO

Laminate: _____





Upholstery Color: _____

Logo: YES NO (Please Circle – If YES, please email EPS file of requested logo to joep@hausmann.com)

Accessories / Options

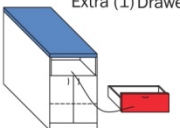
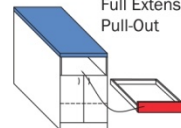
Model #	Quantity	Model #	Quantity
A914	_____	A941	_____
A918	_____	A943	_____
A923	_____	A944	_____
A924	_____	A945	_____
A926	_____	A946	_____
A927	_____	A947	_____
A929	_____	A9250	_____

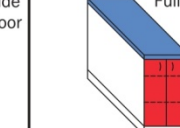
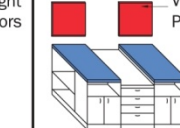
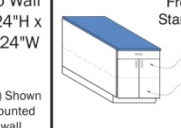
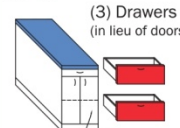
PROTEAM™ OPTIONS (SPECIFY ON ORDER)

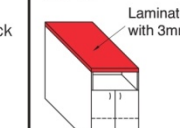
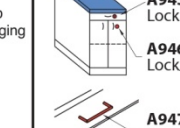
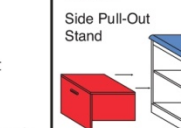
A914 Extra (1) Drawer 	A918 Full Extension Pull-Out 	A943 Hinged Side Access Door 	A944** Full Height Doors 	A9250 Velcro Wall Pad 24"H x 24"W (2) Shown mounted to wall 	A927** Front Pull-Out Stand & Drawer 
A923** (3) Drawers (in lieu of doors) 	A924** Waste Hamper and Cut Out 	A926** Fixed 75° Upholstered Back 26"H x 10"D Only available on 42"D or 48"D units 	A941** Laminate Top with 3mm edging 	A945** Lock A946** Lock/Bolt A947 4" Satin Finish Wire Pull 	A929** Side Pull-Out Stand 

**FACTORY INSTALLED

NOTE: All dimensions shown are nominal. Please define exact length if wall to wall.

See next page for Taping Station Layout

Taping Station Layout

TOP VIEW:

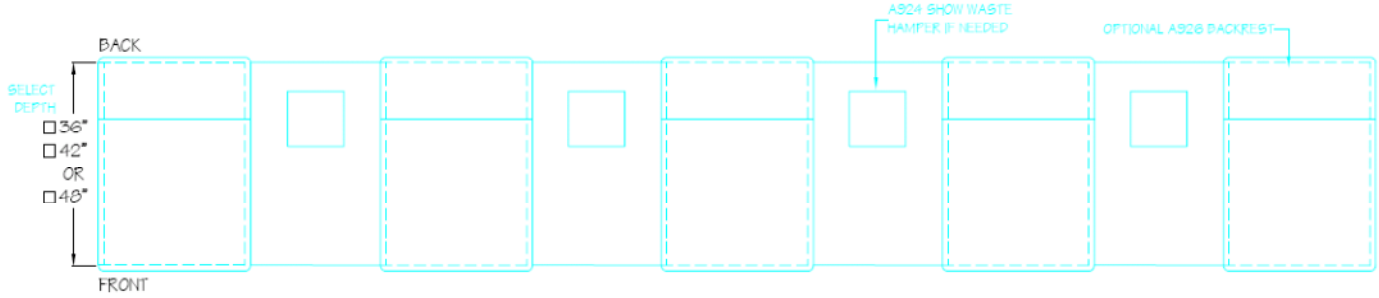

FRONT ELEVATION VIEW:

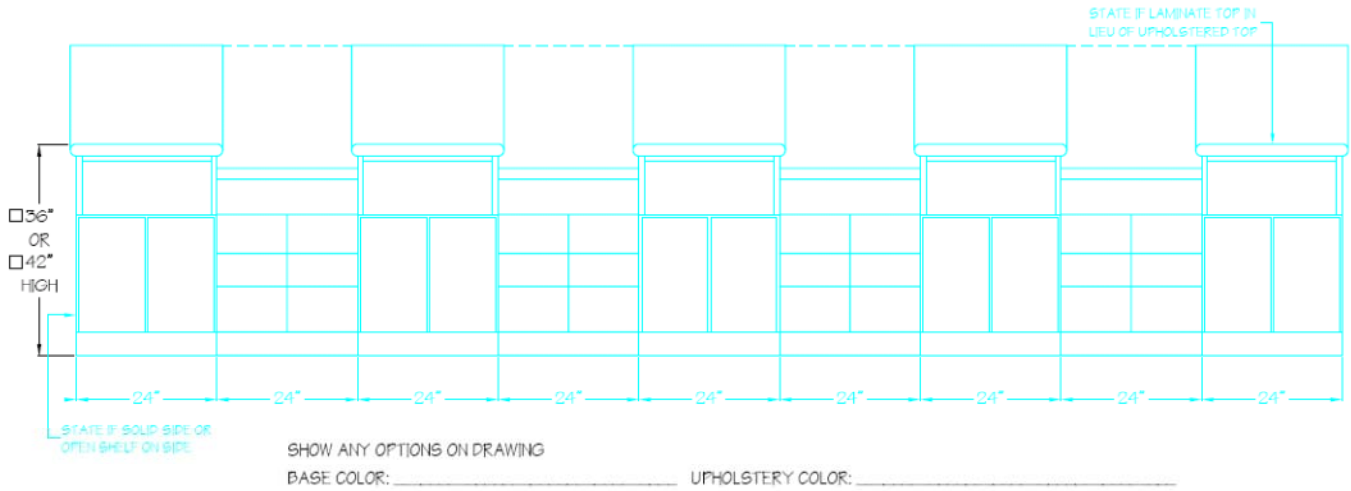

Taping Station Layout Example

